

SEWER LEGEND:	WATER LEGEND:
CLEAN OUT	INSTALLED BLOW OFF
PROPOSED SEWER MANHOLE	WATER MAIN
EXISTING SEWER MANHOLE	INSTALLED GATE VALVE
ISOLATION VALVE	REDUCER
EXISTING SEWER LINE	INSTALLED FIRE HYDRANT
SEWER MAIN	INSTALLED WATER SERVICE
SEWER SERVICE	INSTALLED 6" WATER LINE
GRINDER PUMP	INSTALLED 8" WATER LINE
	INSTALLED WATER LINE

NOTE: PROPOSED SEWER MAINS IS TO HAVE TRACER WIRE. ALSO A NON-BIODEGRADABLE TAPE IDENTIFYING THE LINE AS "SEWER" MUST BE BURIED IN THE TRENCH ABOVE THE SEWER MAINS.

NOTE: ALL FIRE HYDRANT LEADERS HAVE A GATE VALVE BETWEEN MAIN AND FIRE HYDRANT.

AS-BUILTS

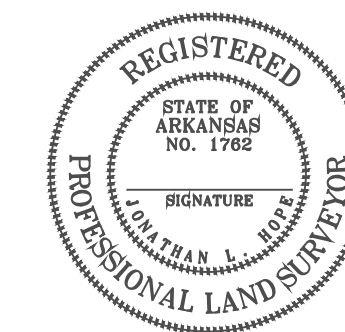
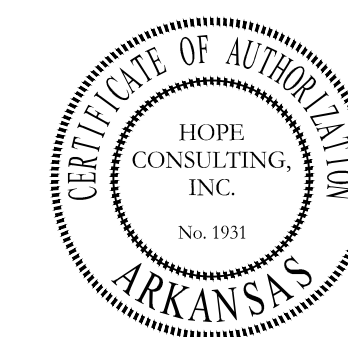

By affixing my seal and signature, I Jonathan L. Hope, PLS No. 1762, hereby certify that this drawing correctly depicts a survey compiled under my supervision.

NOTE: This survey was based on legal descriptions and title work furnished by others and does not represent a title search.

According to the Federal Emergency Management Agency (FEMA) Flood Insurance Rate Map (FIRM) for Saline County, City of Benton, panel # 03125C02401, dated 06/05/2020, most of the property described hereon does not lie within the 100 year flood hazard boundary.

HOPE CONSULTING
ENGINEERS - SURVEYORS

129 North Main Street
Benton, Arkansas 72015
Office: (501) 315-2626
Fax: (501) 315-0024
www.hopeconsulting.com

FOR USE AND BENEFIT OF:
GIRON BUILDERS INC.

JACOB'S CORNER
SANITARY SEWER AND WATER AS-BUILTS
SALINE COUNTY, ARKANSAS

DATE: 10/24/2023	C.A.D. BY: JPP	DRAWING NUMBER:
REVISED:	CHECKED BY:	20-0722
SHEET:	SCALE: 1" = 40'	
500	01S	14W 0 03 320 62 1762