

P.O. Box 116 3825 Mt Carmel Rd
 Benton, AR 72018 Bryant, AR 72022
 Ph (501) 408-4650 garnatengineering@gmail.com

FOR EXCLUSIVE USE & BENEFIT OF:

Name: BART FERGUSON

LEGEND

- △ - Computed point
- - Found monument
- - Set #4 RB/Plas. Cap
- (M) - Measured
- (R) - Record
- (P) - Platted

NOTES:

1. WILL UTILIZE DUMPSTER ON LOT 19R OF PHASE 3 PER APPROVED SCHEMATIC PLAN. DUMPSTER ENCLOSURE WILL COMPLY W/ CITY OF BRYANT STANDARDS.

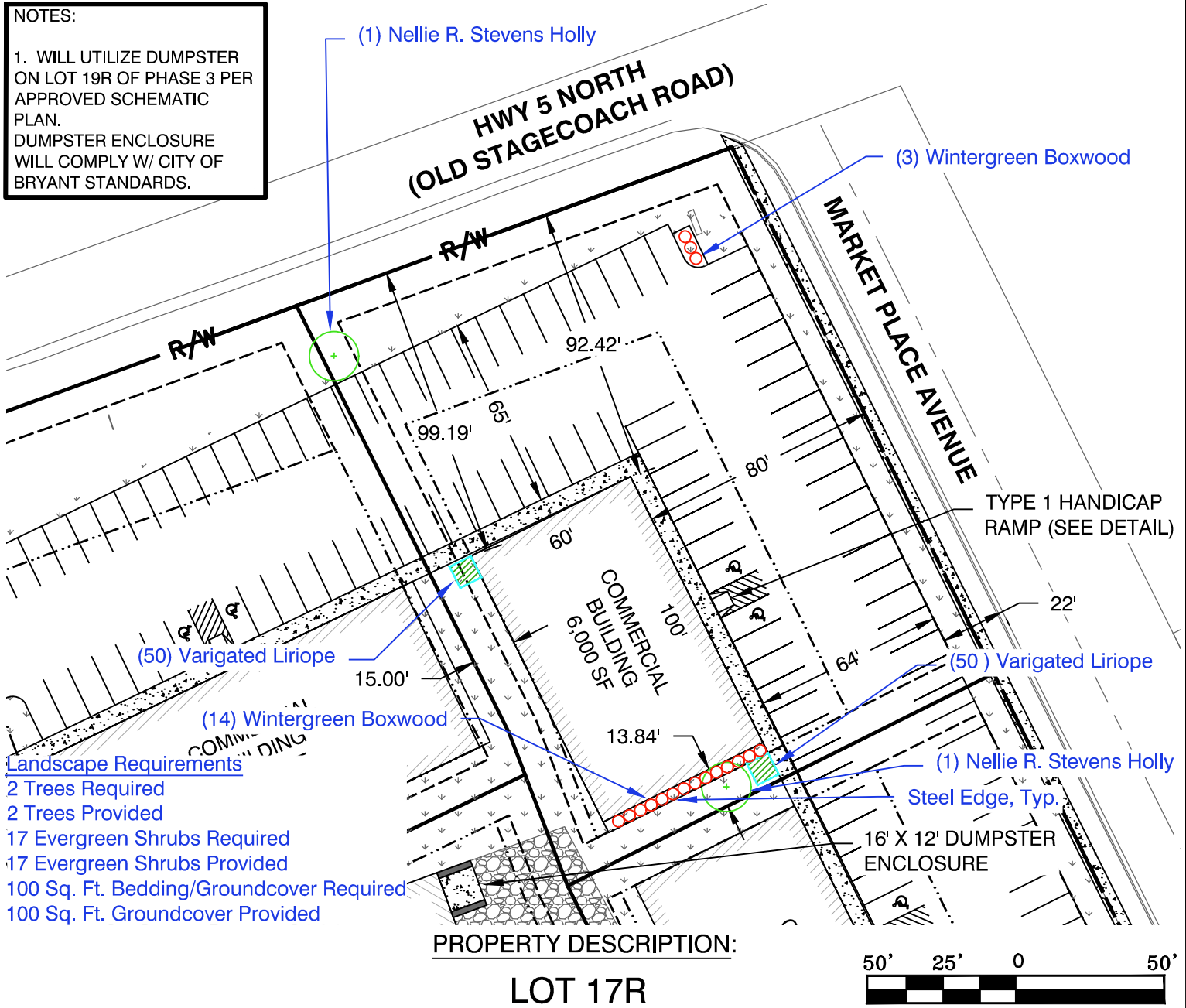

Landscape Requirements

- 2 Trees Required
- 2 Trees Provided
- 17 Evergreen Shrubs Required
- 17 Evergreen Shrubs Provided
- 100 Sq. Ft. Bedding/Groundcover Required
- 100 Sq. Ft. Groundcover Provided

JOB NUMBER:

**18087
 MARKET PLACE II
 PHASE 3**

05/08/24

PLOT PLAN

This Plot Plan depicts the lot as it appears on the subdivision final plat. This drawing does not represent an actual survey.

According to the the Federal Emergency Management Agency (FEMA) Flood Insurance Rate Map (FIRM) for Saline County unincorporated areas, panel # 05125C0240E dated JUNE 05, 2020, no portion, dated of the property described hereon does lie within the 100 year flood hazard boundary.

