

Holloway Engineering,
Surveying & Civil Design
200 Casey Drive
Maumelle, AR 72113
(501) 851-3366
www.holloway-eng.com

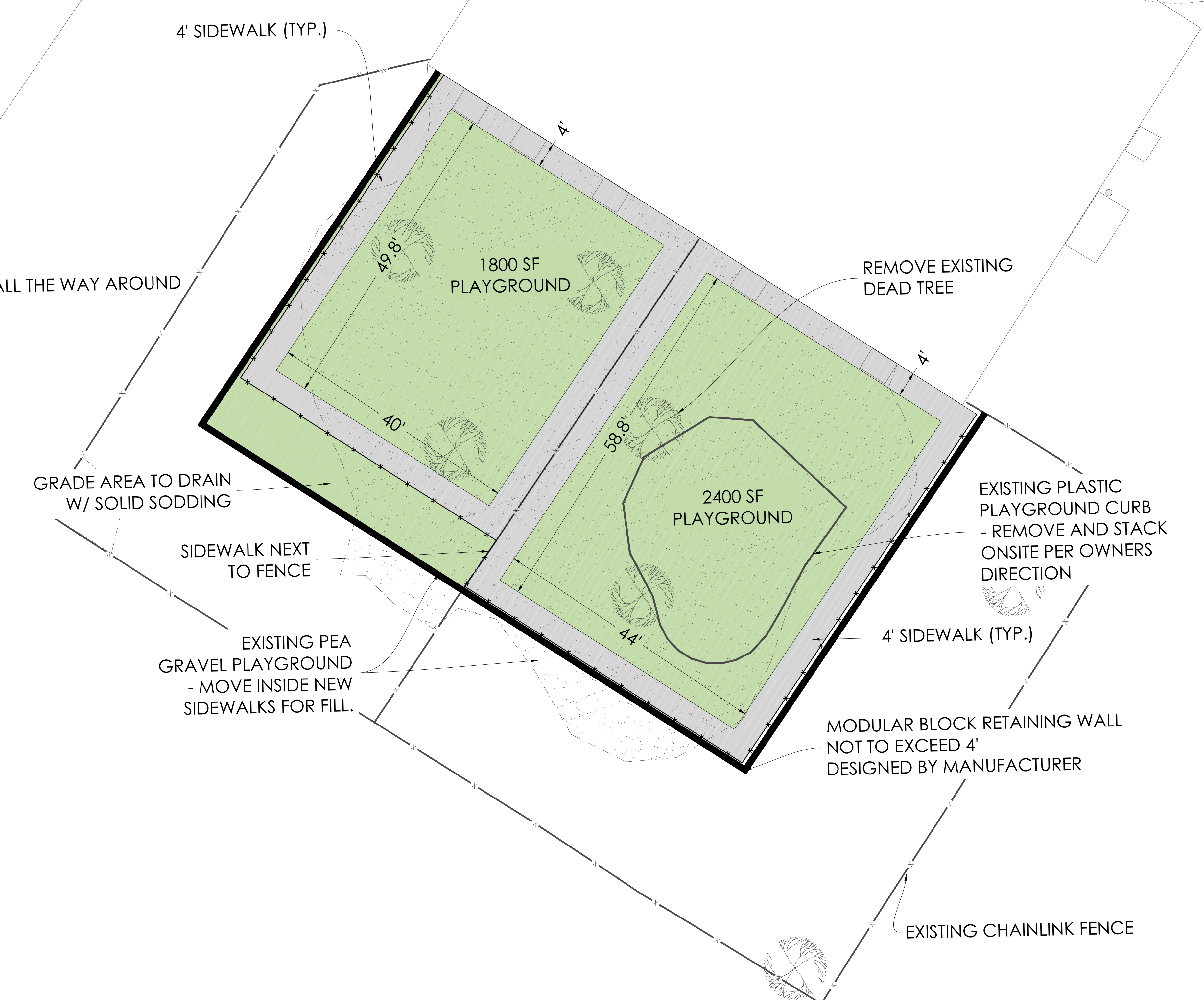
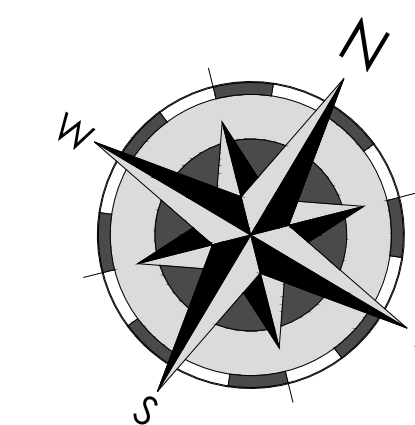

- GENERAL NOTES
1. LOCATIONS OF THE EXISTING UTILITIES ARE BASED ON RECORDS FROM SAID UTILITY COMPANIES AND ARE HORIZONTALLY FIELD LOCATED ONLY. THE CONTRACTORS SHALL BE RESPONSIBLE FOR DETERMINING ACTUAL LOCATION.
 2. CONTRACTOR TO UNCOVER AND MARK UTILITY LINES BEFORE CONSTRUCTION.
 3. CONTRACTOR SHALL BEAR ALL RESPONSIBILITY AND COST OF REPAIR OR REPLACEMENT OF EXISTING UTILITIES, DAMAGED OR INTERRUPTED AS A RESULT OF THIS CONSTRUCTION PROJECT.
 4. CONTRACTOR SHALL NOTIFY THE PROJECT ENGINEER AND THE OWNER OF ANY DAMAGED OR INTERRUPTED UTILITIES IMMEDIATELY.
 5. EXISTING UTILITIES TO REMAIN ARE TO BE ADJUSTED TO MATCH PROPOSED GRADE.
 6. CONTRACTOR SHALL NOTIFY PROJECT ENGINEER PRIOR TO BEGINNING WORK.
 7. CONTRACTOR WILL CONTROL AND PREVENT OFF-SITE TRACKING OF CONSTRUCTION RUNOFF AND SEDIMENT TO ADJACENT PROPERTY AND PUBLIC ROADS.
 8. CONTRACTOR IS TO PROTECT EXISTING STORM DRAINAGE SYSTEM ACCORDING TO PROTECTION ILLUSTRATIONS PROVIDED.
 9. CONTRACTOR TO CONFORM TO ALL CONSTRUCTION STORM WATER AND EROSION CONTROL PERMITTING REQUIREMENTS BY "EPA PHASE II STORM WATER REGULATIONS" AS ADMINISTERED BY THE ARKANSAS DEPARTMENT OF ENVIRONMENTAL QUALITY (ADEQ). WHERE PERMITTING IS REQUIRED, A COPY OF THE NOTICE OF INTENT SHALL BE PROVIDED TO THE LOCAL MUNICIPAL AUTHORITY.
 10. CONTRACTOR SHALL LOCATE ALL EXISTING UTILITIES IN ACCORDANCE WITH THE ARKANSAS UNDERGROUND FACILITIES DAMAGE PREVENTION ACT. THIS LAW REQUIRES THAT THE CONTRACTOR MAKE A TELEPHONE CALL TO THE ARKANSAS ONE-CALL SYSTEM AT 1-800-482-8998 AT LEAST TWO WORKING DAYS PRIOR TO EXCAVATION TO ENSURE THAT ANY EXISTING UTILITIES CAN BE LOCATED.

REV.	DATE	DESCRIPTION

NLC SALINE COUNTY
BRYANT, SALINE COUNTY, AR
FOR NLC SALINE

SITE PLAN

DRAFT
This document is preliminary in nature and is not a final signed and sealed document.

JOB NO.: 2022-044
DATE: 9/10/24
DRAWN BY: TJH
SHEET NUMBER:

C1.00